

# GTX Generation-II Installation Guide

©Steve in NC 2009

**VERIFY THAT THE GUN IS  
UNCOCKED AND UNLOADED!  
!!SAFETY FIRST!!**

1. REMOVE STOCK SCREWS: #24 (x2) AND #36.  
NOTE: SOME AIRGUNS - e.g. GAMO STUTZEN -  
RAPID Mk1- MAY DIFFER.
2. LIFT ACTION #15 FROM STOCK #31.

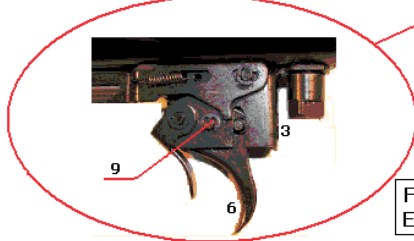

FLIP THE ACTION OVER FOR  
EASIER ACCESS TO TRIGGER

3. REMOVE TRIGGERBLADE PIVOT PIN #9. REMOVE NO OTHER PINS!
4. REMOVE OEM TRIGGER BLADE #6 FROM TRIGGER ASS'Y #3. SLIDE FAT PIN #11 FROM BLADE. NOTE ORIENTATION. SET BLADE ASIDE.

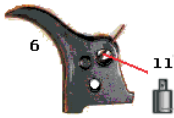

5. REMOVE THE OEM TRIGGER ADJ. SCREW #15, AND THE PLASTIC BLOCK #16 IT SCREWED INTO. SET THOSE PARTS ASIDE.

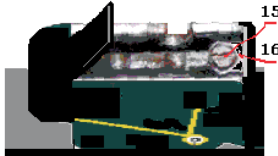

6. CHECK FIT OF PIVOT PIN #9 IN GTX BLADE FOR FREE ROTATION. IF TIGHT, ROTATE AND SLIDE TO CLEAR SURFACE ROUGHNESS UNTIL FREE. REMOVE PIN.

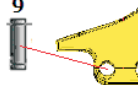

7. INSERT FAT PIN #11 INTO GTX BLADE (NOTE CORRECT ORIENTATION). FROM STEP #4.

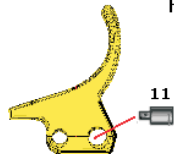

8. INSTALL GTX INTO TRIGGER HOUSING. INSURE THAT STRUT #5 FALLS INTO GROOVE #18 IN GTX. REINSTALL PIVOT PIN #9 THROUGH HOUSING AND GTX. REPLACE E-CLIP #2. LUBRICATE POINTS OF CONTACT APPROPRIATELY. CHECK FOR FREE AND SMOOTH ROTATION OF GTX AROUND PIVOT PIN. REMOVE AND CLEAR ANY INTERFERENCE. **ADJUST GTX SCREWS ACCORDING TO INSTRUCTIONS WITH 0.050" ALLEN WRENCH (PROVIDED) AS NEEDED.**

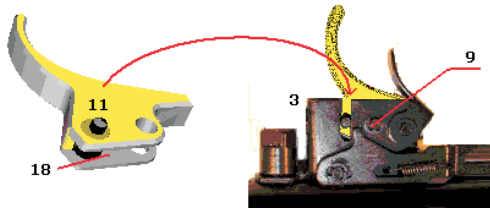

9. REASSEMBLE GUN, TEST, AND REFINE GTX ADJUSTMENTS ACCORDING TO INSTRUCTIONS.

## OEM TRIGGER ASS'Y PARTS

NOTE: SHOWN ONLY FOR  
GENERAL INFO.  
DISASSEMBLY IS NOT REQ'D  
FOR GTX INSTALLATION!

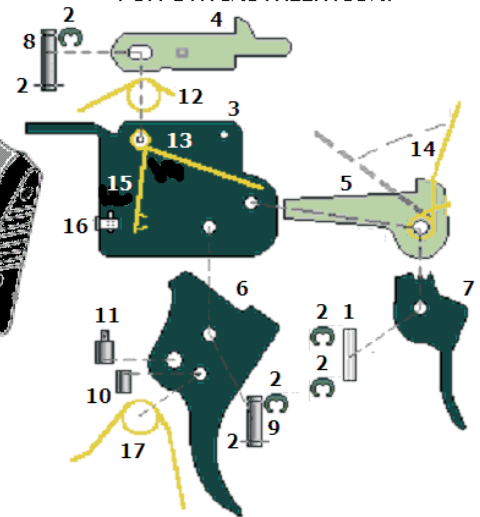

- |                   |                        |
|-------------------|------------------------|
| 1 STRUT PIN       | 14 STRUT SPRING        |
| 2 E CLIPS (6)     | *15 ADJ. SCREW         |
| 3 HOUSING         | *16 ADJ. PLASTIC BLOCK |
| 4 SEAR            | *17 BLADE SPRING       |
| 5 STRUT           |                        |
| *6 BLADE          |                        |
| 7 SAFETY TOGGLE   |                        |
| 8 SEAR PIN        |                        |
| 9 BLADE PIVOT PIN |                        |
| *10 SPRING PIN    |                        |
| 11 FAT PIN        |                        |
| 12 SEAR SPRING    |                        |
| 13 SAFETY SPRING  |                        |
- \* = REMOVED OR REPLACED  
IN GTX INSTALLATION

**WARNING: WHEN SHOOTING WITH THE GTX FOR THE FIRST TIME, DON'T EVEN TOUCH THE TRIGGER WITHOUT FIRST POINTING THE MUZZLE IN A SAFE DIRECTION. YOU WILL BE SURPRISED!**